

# TANDBERG DATA

Securing your Information



## **DAT 160 and DAT 72 USB Tape Drive**

*User Guide*

*Part Number 1018932 - August 2009*

[www.tandbergdata.com](http://www.tandbergdata.com)

## Copyright

© Copyright 2008 Tandberg Data Corporation.

All rights reserved. This item and the information contained herein are the property of Tandberg Data Corporation. No part of this document may be reproduced, transmitted, transcribed, stored in a retrieval system, or translated into any language or computer language in any form or by any means, electronic, mechanical, magnetic, optical, chemical, manual, or otherwise, without the express written permission of Tandberg Data Corporation, 2108 55th Street, Boulder, Colorado 80301.

**DISCLAIMER:** Tandberg Data Corporation makes no representation or warranties with respect to the contents of this document and specifically disclaims any implied warranties of merchantability or fitness for any particular purpose. Further, Tandberg Data Corporation reserves the right to revise this publication without obligation of Tandberg Data Corporation to notify any person or organization of such revision or changes.

**TRADEMARK NOTICES:** Tandberg Data Corporation trademarks: Tandberg Data, Exabyte, the Exabyte Logo, EZ17, M2, SmartClean, VXA, and VXAtape are registered trademarks; MammothTape is a trademark; SupportSuite is a service mark. Other trademarks: All other product names are trademarks or registered trademarks of their respective owners.

**Note:** The most current information about this product is available at Tandberg Data's web site (<http://www.tandbergdata.com>).

**Part Number** 1018932



# Contents

<b>About this guide .....</b>	<b>VII</b>
Intended audience .....	VII
Technical support .....	VII
Product warranties .....	VII
Document conventions and symbols .....	VII
<b>1 Before you start .....</b>	<b>9</b>
DAT tape drive models .....	9
Which operating systems are supported? .....	10
How do I connect the drive to my server? .....	11
What are the mounting requirements for an internal tape drive? .....	11
Power requirements .....	11
Drivers .....	11
Backup software .....	12
<b>2 Installing an internal DAT tape drive .....</b>	<b>13</b>
Prepare mounting bay .....	13
Attach mounting hardware .....	14
Install drive .....	15
Attach cables .....	16
Secure the drive .....	17
<b>3 Installing an external DAT tape drive .....</b>	<b>19</b>
Important information before you start .....	19
Connecting the power and USB cables .....	19
<b>4 Verify installation .....</b>	<b>21</b>
<b>5 Operating your tape drive .....</b>	<b>23</b>
Front panel .....	24
LED sequences .....	24
LED sequences for the DAT 160 tape drive .....	24
LED sequences for the DAT 72 tape drive .....	26
Loading and unloading cartridges .....	28
Inserting cartridges .....	28
Removing cartridges .....	29
Removing power from the drive .....	29

<b>6</b>	<b>Use the correct media .....</b>	<b>31</b>
	Data cartridges .....	31
	DAT 160 tape drives and DAT 160 cartridges .....	31
	Compatibility .....	31
	Write-protecting cartridges .....	32
	Cleaning cartridges .....	33
	Handling cartridges .....	34
	Getting the most out of cartridges and drives .....	34
<b>7</b>	<b>Troubleshooting .....</b>	<b>37</b>
	General Procedure .....	37
	Verifying USB installation for optimum performance .....	38
	Check for USB 2.0 port (Windows) .....	39
	Ensure that the tape drive is the only device on a USB hub (Win-	
	dows) .....	39
	Ensure that the hp_usbstor driver is being used (Windows) .....	39
	Check drivers (Linux) .....	40
	Problems with cartridges .....	40
	The cartridge is jammed .....	41
	The drive will not accept the cartridge (or ejects it immediately) .....	41
<b>8</b>	<b>USB Configuration Guide .....</b>	<b>43</b>
	USB in DAT devices .....	43
	USB terminology .....	43
	Setting up a USB network .....	44
	USB cables .....	45
	<b>Index .....</b>	<b>47</b>



# Figures

<b>Figure 1-1</b>	Front view of DAT 160 tape drive .....	10
<b>Figure 1-2</b>	Front view of DAT 72 tape drive .....	10
<b>Figure 2-1</b>	Example, attaching mounting screws .....	15
<b>Figure 2-2</b>	Installing the tape drive .....	16
<b>Figure 2-3</b>	Attaching cables .....	17
<b>Figure 2-4</b>	Securing drive example 1, mounting hardware used .....	18
<b>Figure 2-5</b>	Securing drive example 2, no mounting hardware used .....	18
<b>Figure 3-1</b>	Connecting power and USB cables .....	20
<b>Figure 5-1</b>	Front panel, DAT 160 tape drive .....	24
<b>Figure 5-2</b>	Front panel, DAT 72 tape drive .....	24
<b>Figure 5-3</b>	Inserting a data cartridge (into a DAT 160 external drive) .....	28
<b>Figure 5-4</b>	Ejecting a cartridge (from an external drive) .....	29
<b>Figure 6-1</b>	Write protecting a cartridge .....	33

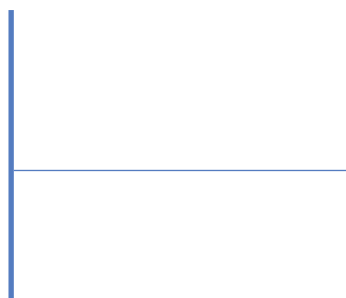

# Tables

<b>Table 1</b>	Document conventions .....	VIII
<b>Table 1-1</b>	Power requirements .....	11
<b>Table 5-1</b>	LED sequences for DAT 160 .....	25
<b>Table 5-2</b>	LED sequences for DAT 160, continued .....	26
<b>Table 6-1</b>	Data cartridge compatibility .....	32
<b>Table 6-2</b>	Cleaning cartridge compatibility .....	33

## About this guide

This guide provides information about:

- Installing the Tandberg Data DAT USB tape drive
- Using the Tandberg Data DAT USB tape drive
- Troubleshooting the Tandberg Data DAT USB tape drive

## Intended audience

This guide is intended for users who install, operate and maintain the Tandberg Data DAT tape drive.

## Technical support

For worldwide technical support information, please visit the support pages at <http://www.tandbergdata.com>.

Before contacting support, collect the following information:

- Product model names and numbers
- Technical support registration number (if applicable)
- Product serial numbers
- Error messages
- Operating system type and revision level
- Detailed questions

## Product warranties

For information about product warranties, please visit the support pages at <http://www.tandbergdata.com>.

## Document conventions and symbols

**Note:** Provides additional information.



**Warning** Indicates that failure to follow directions could result in bodily harm or death.



**Caution** Indicates that failure to follow directions could result in damage to equipment or data.



**Important** Provides clarifying information or specific instructions.

**Table 1** Document conventions

Convention	Element
Blue text: <a href="#">Table 1</a> on page VIII	Cross-reference links and e-mail addresses
Blue, underlined text: <a href="http://www.tandbergdata.com">http://www.tandbergdata.com</a>	website addresses
<b>Bold</b> text	<ul style="list-style-type: none"> <li>• Keys that are pressed</li> <li>• Text typed into a GUI element, such as a box</li> <li>• GUI elements that are clicked or selected, such as menu and list items, buttons, tabs, and check boxes</li> </ul>
<i>Italic</i> text	Text emphasis
Monospace text	<ul style="list-style-type: none"> <li>• File and directory names</li> <li>• System output</li> <li>• Code</li> <li>• Commands, their arguments, and argument values</li> </ul>
<i>Monospace, italic</i> text	<ul style="list-style-type: none"> <li>• Code variables</li> <li>• Command variables</li> </ul>
<b>Monospace, bold</b> text	Emphasized monospace text

# 1

## Before you start

In this chapter:

- “DAT tape drive models” on page 9
- “Which operating systems are supported?” on page 10
- “How do I connect the drive to my server?” on page 11
- “What are the mounting requirements for an internal tape drive?” on page 11
- “Drivers” on page 11
- “Backup software” on page 12

### DAT tape drive models

This guide describes how to install and operate the following Tandberg Data DAT USB tape drive models:

- Tandberg Data DAT 160 internal and external tape drive
- Tandberg Data DAT 72 internal and external tape drive

For a detailed product specification, please visit the support pages at <http://www.tandbergdata.com>.

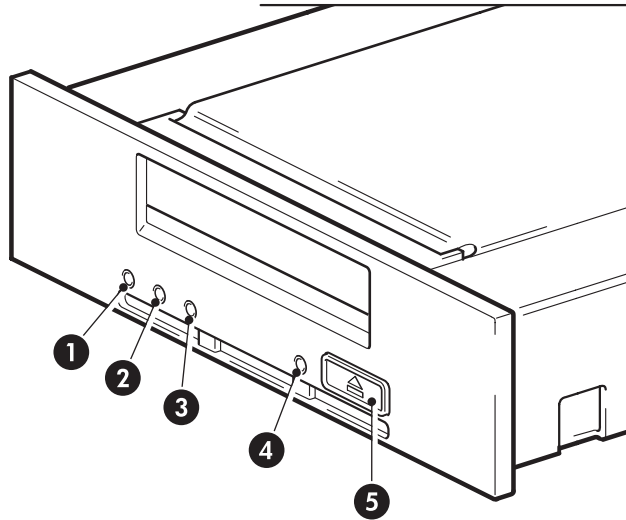

- 1. Clean LED
- 2. Tape LED
- 3. Drive LED
- 4. Ready LED
- 5. Eject button

**Figure 1-1** Front view of DAT 160 tape drive

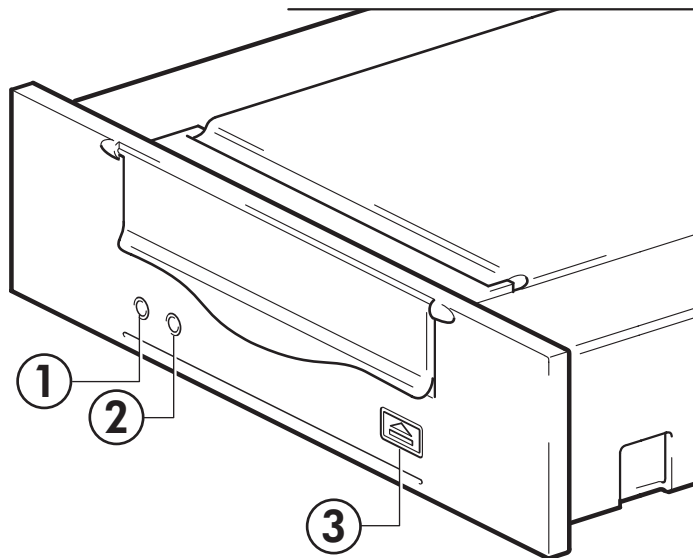

- 1. Clean LED
- 2. Tape LED
- 3. Eject button

**Figure 1-2** Front view of DAT 72 tape drive

## Which operating systems are supported?

DAT tape drives can be connected to servers running under Windows®, Linux and other major operating systems. Please visit the support pages at <http://www.tandbergdata.com> for the most recent information about the operating system versions that are supported.

## How do I connect the drive to my server?

For optimum performance the drive should be connected to a USB 2.0 port and it should be the only device on the USB bus. Although the tape drive will function on USB 1.1, performance will be severely degraded. See also “[Verifying USB installation for optimum performance](#)” on page 38.

## What are the mounting requirements for an internal tape drive?

You need one industry-standard, 5¼-inch, half-height bay in which to install the Tandberg Data DAT tape drive. For many servers, no mounting tray or rails are required. Devices simply slide into the server's chassis and are fixed with screws. Other servers have built-in trays or rails.

Some servers use non-standard mounting rails and do not include spares. If this is the case with your system, you will have to order these accessories from the server manufacturer before you can install the tape drive.

## Power requirements

Power requirements are:

**Table 1-1** Power requirements

Voltage	Typical Current		Maximum Current	
	DAT 160	DAT 72	DAT 160	DAT 72
5 V	1.54 A	0.7 A	1.61 A	0.8 A
12 V	0.26 A	0.3 A	1.3 A	1.0 A

## Drivers

Two drivers are required in order to use DAT USB tape drives.

The manufacturer's Tape driver is suitable for use in most applications, but refer also to the documentation of your software application to ensure you are using the recommended driver.

On Windows systems, we strongly recommend that you use the installer package supplied by your manufacturer to install the drivers. Updates to the drivers may be provided from time to time on <http://www.tandbergdata.com>. We recommend that these are installed after using the installer package.

On Linux and UNIX operating systems, drivers are included with the operating system and should be loaded automatically. To upgrade drivers we recommend that you patch to the latest version of the operating system.

## Backup software

For optimum performance it is important to use a backup application that is appropriate for your system's configuration. In a direct attach configuration, where the tape drive is attached to a standalone server, you can use backup software that is designed for a single server environment. In network configurations you will need backup software that supports enterprise environments.

Further details about suitable products can be found on <http://www.tandbergdata.com>. It is important to check for software compatibility and install any recommended upgrades.

**Note:** Certain backup applications require you to use their own Tape driver instead of the manufacturer's Tape driver.

**Note:** The NT backup application is compatible with DAT tape drives, but the user must always choose 4 mm tape even when using 8 mm tape with a Tandberg Data DAT 160 tape drive.

# 2

## Installing an internal DAT tape drive

In this chapter:

- [“Prepare mounting bay”](#) on page 13
- [“Attach mounting hardware”](#) on page 14
- [“Attach cables”](#) on page 16
- [“Secure the drive”](#) on page 17

Please refer to [“Installing an external DAT tape drive”](#) on page 19, if you are installing an external DAT tape drive.

**Note:** It is important to ensure that you connect your drive to a USB 2.0 port. The drive will work on a USB 1.1 port but performance will be severely degraded. See also [“Verifying USB installation for optimum performance”](#) on page 38.

### Prepare mounting bay

You need one industry-standard, 5¼-inch bay in which to install the DAT tape drive.



#### Warning

To avoid personal injury or damage to the server or tape drive, ensure that the server is disconnected from the mains power supply while you install the drive.



#### Caution

Static electricity can damage electronic components. Always wear an antistatic wriststrap if one is available. If not, after you have disconnected power

from the server and removed the cover, touch a bare metal part of the chassis. Similarly, touch a bare metal part of the drive before installing it.

---

1. Refer to your server documentation for detailed instructions and assemble the necessary tools and materials.
2. Perform a normal system shutdown and turn off the server and any connected peripherals.
3. Remove the cover and access panel from the server, as detailed in your server's documentation.

As you work inside the server, you may have to disconnect other signal cables or power cables from other devices to maneuver the new drive into place. If you have to do this, make a note of their position and connections so you can put them back correctly later.

4. Remove the filler panel from a spare 5¼-inch bay of your server, as described in your server's documentation. With some servers you may also need to remove the half-height device divider. Keep any screws for use in “[Secure the drive](#)” on page 17.
5. You are now ready to install your tape drive.

## Attach mounting hardware

If your server requires special rails or other hardware to install the tape drive, mount them on the tape drive now. *If your server does not require special mounting hardware, ignore this section.*

Different models of server require different mounting methods. Please check your server documentation to ascertain the correct method of mounting, and to check whether mounting hardware is provided with the server or must be purchased separately.

**Note:** If mounting hardware is supplied with your tape drive, it may not be exactly the same as shown in the illustrations.

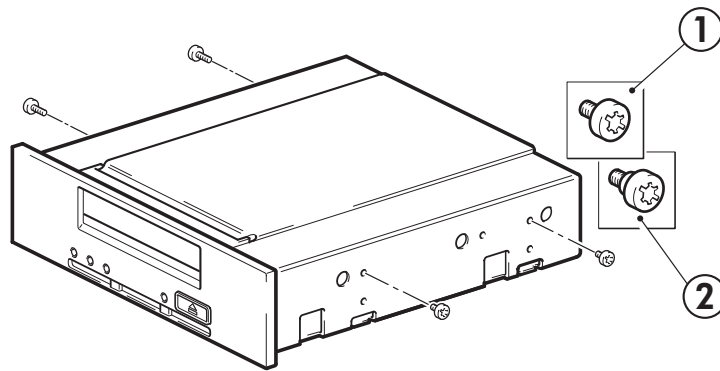

1. M3 mounting screws

2. M3 offset mounting screws

**Figure 2-1** Example, attaching mounting screws

## Install drive



### Caution

Static electricity can damage electronic components. Always wear an antistatic wriststrap if one is available. If not, after you have disconnected power from the server and removed the cover, touch a bare metal part of the chassis. Similarly, touch a bare metal part of the drive before installing it.

Slide the tape drive into the open bay, aligning the tray or rails with the slots in the bay.

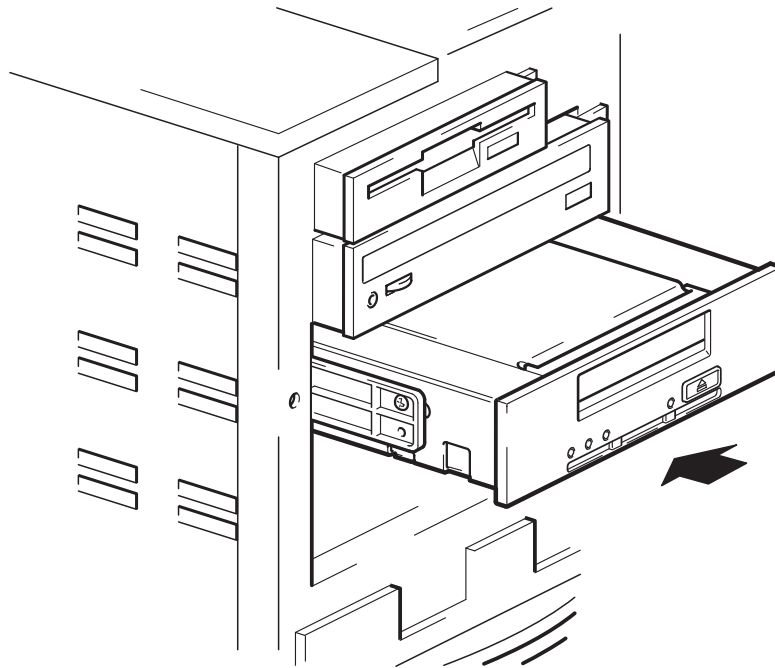

**Figure 2-2** Installing the tape drive

The illustration shows a tape drive that has mounting rails fitted. If your server does not use mounting hardware, check that the holes in the chassis are aligned with the holes in the side of the tape drive.

Do not secure the drive at this point because you may have to move the drive to get the cables into place.

## Attach cables

The drive is not powered from the USB bus. It must be connected to the server's power supply.

The tape drive is connected to an internal USB port on your server. Use the schematic on the inside of the server panel to check whether the server has an internal USB port and locate its position. If your server does not have an internal USB 2.0 port, you will need to purchase and install a suitable USB host adapter before connecting the USB tape drive. Please visit the support pages at <http://www.tandbergdata.com> for recommended products.

1. Use a USB cable with a 4-pin Intel connector to connect to the server. Use cable ties, as required, to tidy excess cable length.

2. Attach a spare power cable from the server's internal power supply to the power connector.

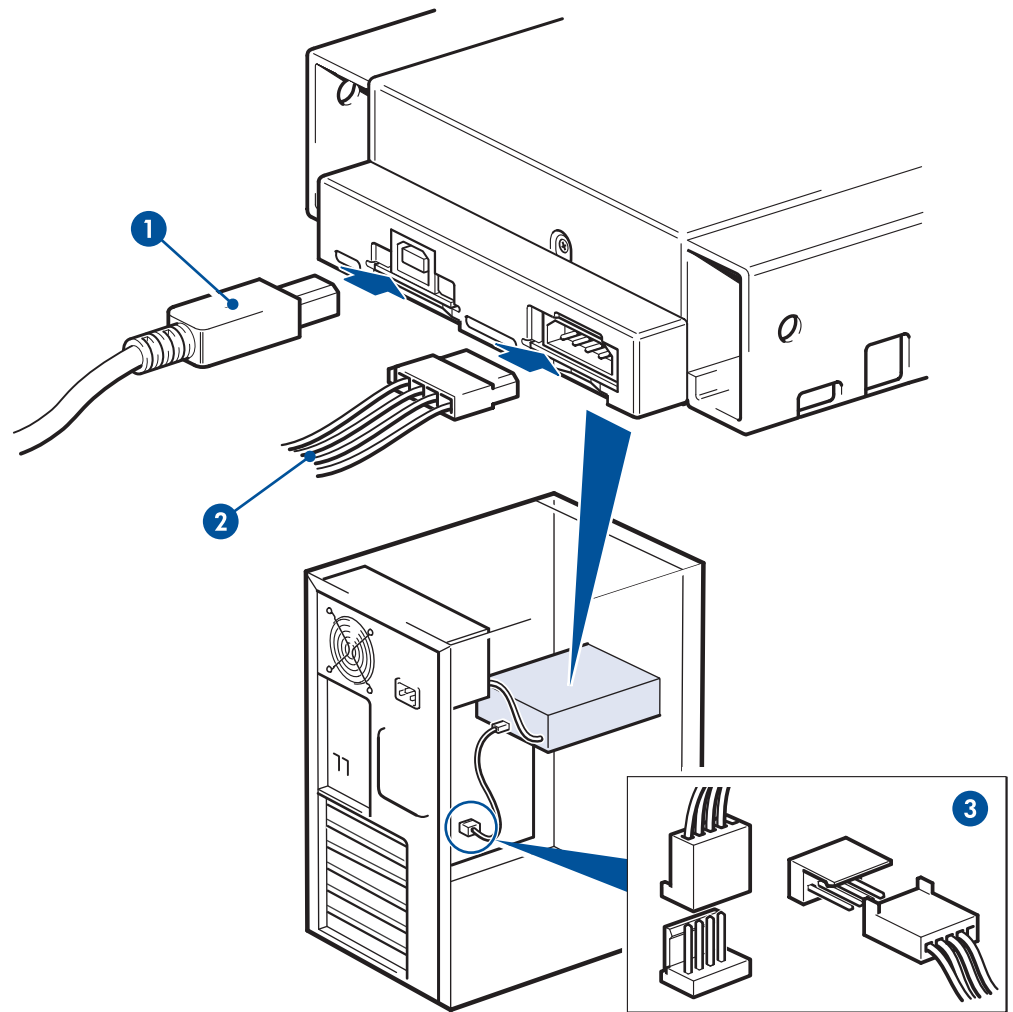

1. USB cable to tape drive

3. USB cable to server's USB port

2. power cable

**Figure 2-3** Attaching cables

## Secure the drive

Secure the drive, as described in your server documentation. Ensure blanking plates are in place over empty bays and replace the cover on the server.

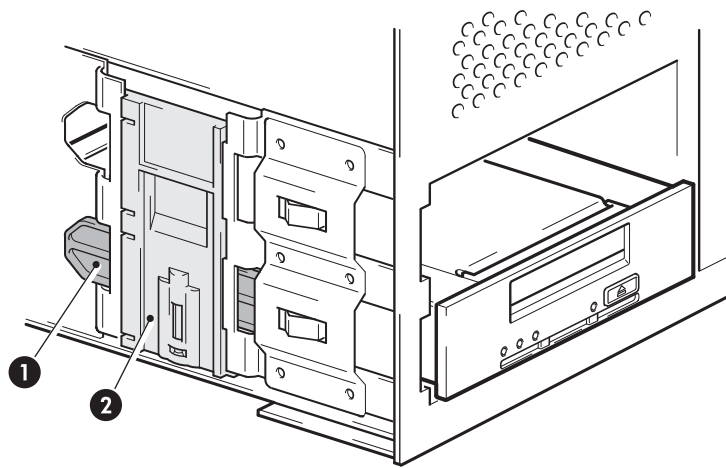

1. plastic rail
2. server latch, push down to lock the tape drive into position

**Figure 2-4** Securing drive example 1, mounting hardware used

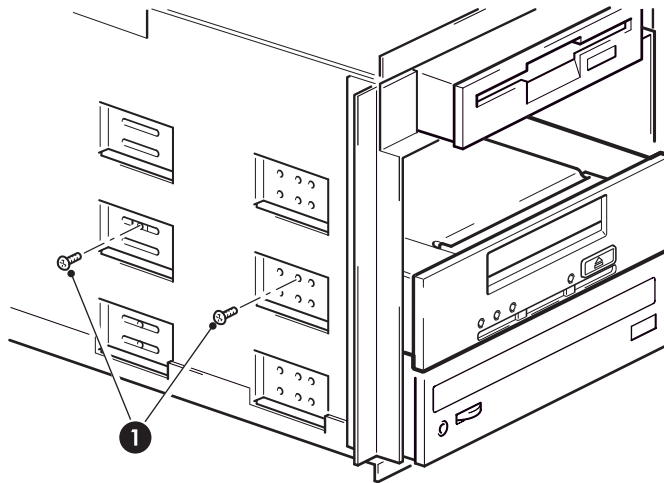

1. M3 screws, supplied with tape drive

**Figure 2-5** Securing drive example 2, no mounting hardware used

# 3

## Installing an external DAT tape drive

In this chapter:

- [“Important information before you start”](#) on page 19
- [“Connecting the power and USB cables”](#) on page 19

Please refer to [“Installing an internal DAT tape drive”](#) on page 13, if you are installing an internal DAT tape drive.

### Important information before you start

An external DAT drive will operate using any voltage in the range 100–240 volts (0.7 A, 50-60 Hz). No adjustment is needed.

A power cord is provided with your DAT tape drive. The USB 2.0 cable is already fitted to the tape drive, you cannot remove it.

The drive is not powered from the USB bus. It must be connected to the mains power supply.

### Connecting the power and USB cables

1. Make sure that the drive is switched OFF (O side down). The power switch is on the rear panel.

2. Plug the power cable securely into the socket on the rear panel of the drive and plug the other end of the power cable into the power outlet.

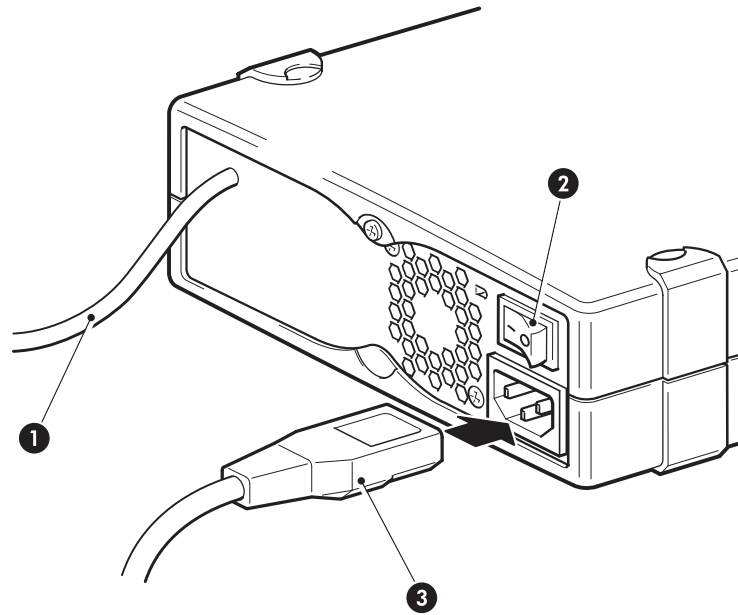

1. USB cable (pre-fitted)
2. on/off switch
3. power cable

**Figure 3-1** Connecting power and USB cables

3. Plug the USB cable into the USB connector on the server.

**Note:** It is important to ensure that you connect your drive to a USB 2.0 port. The drive will work on a USB 1.1 port but performance will be severely degraded. See also [“Verifying USB installation for optimum performance”](#) on page 38.

# 4

## Verify installation

Once you have installed the drive hardware, check that drivers have been installed correctly and you have the correct version of backup software, and verify that the tape drive is functioning properly before you store your valuable data.

**Note:** Certain backup applications require you to use their own Tape driver instead of the HP Tape driver.

1. Switch on the drive and the server.
2. The tape drive will run its hardware self-test, which takes about 5 seconds. At the end of the hardware self-test:
  - **DAT 160 drives:** If self-test passes, the green Ready LED flashes and then shows steady green. If the test fails, the Drive Error and Tape Error LEDs flash, while the Ready and Clean (or Use Cleaning Cartridge) LEDs are off. This continues until the drive is reset.
  - **DAT 72 drives:** If self-test passes, both front panel lights should be off. If a hard error causes the self-test to fail, the clean light changes to steady amber.  
See “[Front panel](#)” on page 24 for more information about front panel lights.
3. Make sure the correct drivers are installed.
  - **Installing drivers (Windows)**  
We recommend that you download the latest driver from <http://www.tandbergdata.com> before installation. If the Windows Found New Hardware wizard runs, follow the on-screen instructions to install drivers from the download location.
  - **Installing drivers (other operating systems)**  
Drivers are included with the operating system and should be loaded automatically. To upgrade drivers we recommend that you patch to the latest version of the operating system.

4. Verify that the tape drive installation was successful.

If you encounter a problem during this verification procedure, turn to “[Troubleshooting](#)” on page 37 for help in diagnosing and fixing the problem.

5. For all operating systems ensure that you have downloaded any upgrades necessary for your backup application. Check <http://www.tandbergdata.com> for software compatibility and install any recommended upgrades.

6. Carry out a backup and restore test to check that the drive can write data to tape. Use a blank cartridge.

Native backup applications can be used to check basic tape drive operation, but they may not support all the advanced features of your tape drive. We recommend that you upgrade your software application before running this test.

# 5

## Operating your tape drive

In this chapter:

- [“Front panel”](#) on page 24
- [“LED sequences”](#) on page 24
- [“Loading and unloading cartridges”](#) on page 28
- [“Removing power from the drive”](#) on page 29

## Front panel

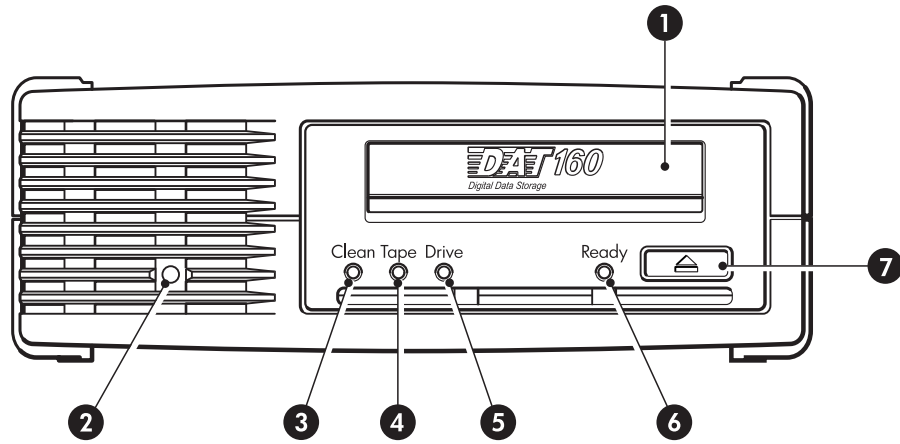

- 1. cartridge slot
- 2. power LED (external drives only)
- 3. clean LED
- 4. tape LED
- 5. drive LED
- 6. ready LED
- 7. eject button

**Figure 5-1** Front panel, DAT 160 tape drive

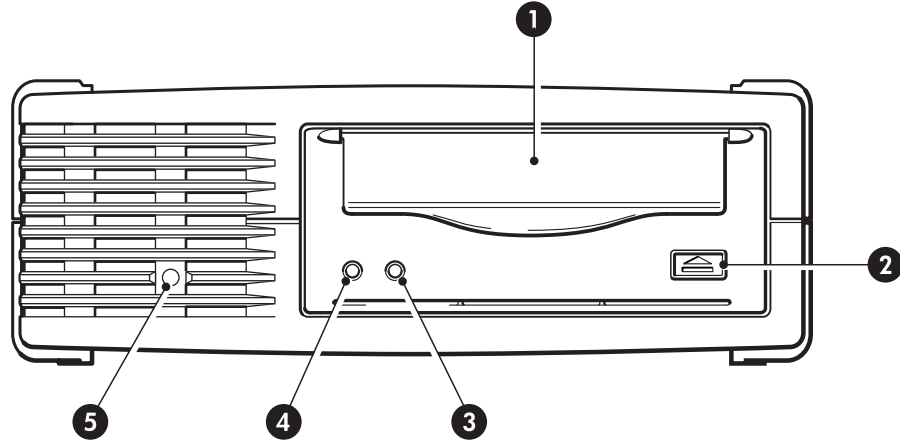

- 1. cartridge door
- 2. eject button
- 3. clean LED
- 4. tape LED
- 5. power LED (external drives only)

**Figure 5-2** Front panel, DAT 72 tape drive

## LED sequences

## LED sequences for the DAT 160 tape drive

The meaning of different patterns of LEDs is as follows:

**Table 5-1** LED sequences for DAT 160

LED Sequence	Cause	Action required
<i>All LEDs OFF.</i>	Drive may not have power, may be faulty or may have been power cycled or reset during a firmware upgrade.	<p>Make sure the drive is switched on. The power on/off switch incorporates a green LED.</p> <p>If this is not on, check the power cable connection and replace the cable if necessary. You can use the power cable from your monitor or another device to check that the connection is working.</p> <p>If the power supply is present and all LEDs remain off, power cycle or reset the drive. If it still fails, call for service.</p>
<i>Ready is ON.</i>	The drive is ready for operation.	None. This is normal.
<i>Ready FLASHES.</i>	The drive is carrying out a normal activity (read, write, clean).	<p>None.</p> <p>If the drive is upgrading firmware, do not reset or power cycle it.</p> <p>If the drive is cleaning, the cleaning cartridge will eject on completion. The cleaning cycle can take up to 5 minutes to complete.</p>
<i>Clean FLASHES.</i>	The drive requires cleaning.	<p>Load the DDS cleaning cartridge. See <a href="#">“Cleaning cartridges”</a> on page 33 for supported cartridges and instructions.</p> <p>If the Clean LED is still flashing when you load a new or known good data cartridge after cleaning, call for service.</p>

**Table 5-2** LED sequences for DAT 160, continued

LED Sequence	Cause	Action required
<i>Tape FLASHES.</i>	The drive believes the current tape or the tape just ejected is faulty.	<p>Unload the tape cartridge. Make sure that you are using the correct format cartridge. (See “<a href="#">Use the correct media</a>” on page 31.)</p> <p>Reload the cartridge. If the Tape LED still flashes or starts flashing during the next backup, load a new or known good cartridge.</p> <p>If the Tape LED is now off, discard the 'suspect' tape cartridge. If it is still on, call for service.</p>
<i>Drive FLASHES.</i>	The drive mechanism has detected an error.	<p>Load a new cartridge. If the error persists, power cycle or reset the drive.</p> <p>If the Drive LED remains on, call for service.</p>
<i>Drive, Tape and Ready FLASH.</i>	There is a firmware download problem.	<p>Insert a cartridge to clear the LED sequence. If the condition persists, call for service.</p>

### LED sequences for the DAT 72 tape drive

There are two LEDs, labeled Tape and Clean. The meaning of different patterns of LEDs is as follows:

Tape LED	Clean LED	Meaning
on	off	The cartridge is loaded and the drive is ready.
flashing slowly	off	The cartridge is loading or unloading, or self-test is in progress.
flashing rapidly	off	The cartridge is loaded, activity is occurring.
off or flashing	on	This is the Error Condition Signal. DAT drives perform a comprehensive self-test during power-up. If a hard error causes the self-test to fail, the clean light changes to steady amber.
off or flashing	flashing slowly	<p>This is the Media Caution Signal.</p> <ol style="list-style-type: none"> <li>1. Wait for the current operation to finish, then insert a different tape and repeat the operation that was being performed.</li> <li>2. If the media caution signal does not show this time, it indicates that the original cartridge was nearing the end of its useful life. Copy any data you want to keep from the original tape onto a new tape if possible, then discard the old tape.</li> <li>3. If the media caution signal appears again with the second tape, the tape heads need cleaning.</li> <li>4. If the media caution signal appears after using a cleaning cartridge, the cleaning cartridge has probably expired and should be discarded.</li> </ol>

## Loading and unloading cartridges

### Inserting cartridges

1. Insert a cartridge into the slot on the front panel. As the cartridge is inserted, the drive takes it and performs a load sequence.

**Note:** The illustration shows a DAT 160 cartridge. These cartridges are wider than earlier-format DDS cartridges and can only be used with DAT 160 tape drives. See “Data cartridges” on page 31 for more information about tape drive and cartridge compatibility.

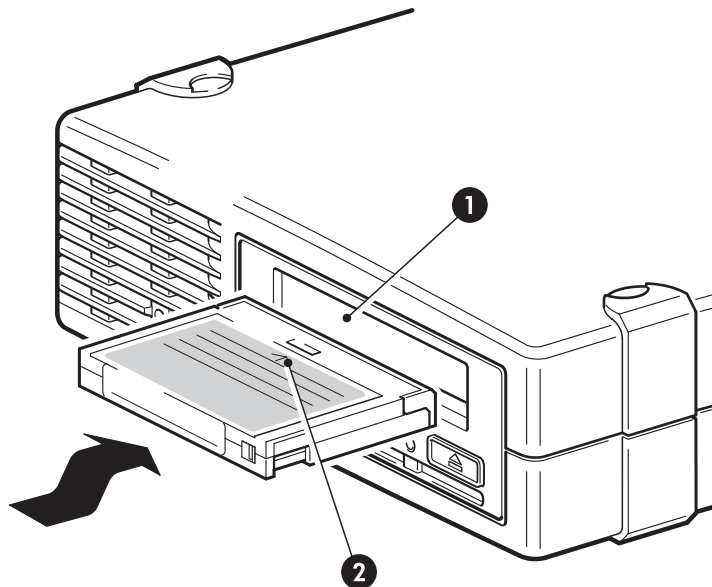

1. cartridge slot
2. arrow indicates leading direction

**Figure 5-3** Inserting a data cartridge (into a DAT 160 external drive)

2. **DAT 160 tape drives:** The Ready light flashes green while the drive performs its load sequence. When the cartridge is loaded, the Ready light shows steady green.

**DAT 72 tpe drives:** The Tape light flashes green while the drive performs its load sequence. When the cartridge is loaded, the Tape light shows steady green.

## Removing cartridges



**Caution** Never try to remove a cartridge before it is fully ejected.

1. Press the Eject button on the front panel.

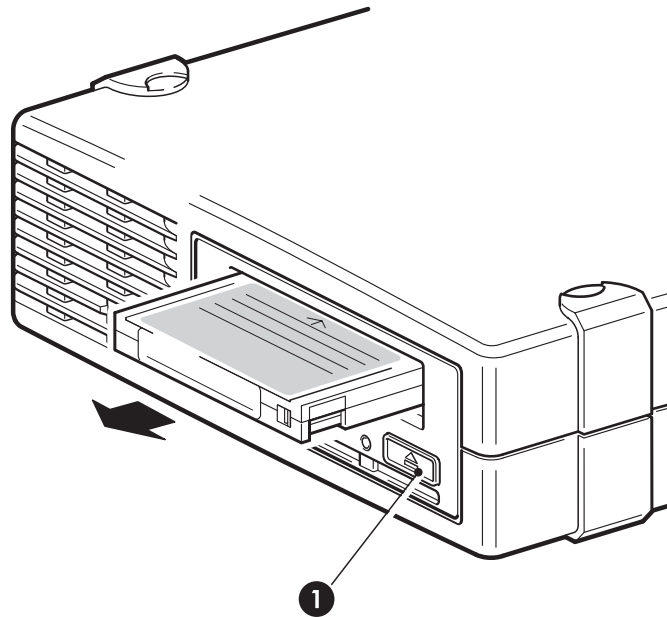

1. eject button

**Figure 5-4** Ejecting a cartridge (from an external drive)

2. The drive completes any task it is currently performing, winds the tape to the beginning, and ejects the cartridge. The sequence will take about 25 seconds for a write-enabled cartridge and 10 seconds for a write-protected cartridge.

## Removing power from the drive

To ensure reliable operation, do not remove power from the drive during read, write, fast-search, load and unload activities.

## Notes

# 6

## Use the correct media

For best performance we recommend branded media, as recommended by your manufacturer.

In this chapter:

- [“Data cartridges”](#) on page 31
- [“Write-protecting cartridges”](#) on page 32
- [“Cleaning cartridges”](#) on page 33
- [“Handling cartridges”](#) on page 34
- [“Getting the most out of cartridges and drives”](#) on page 34

### Data cartridges

#### DAT 160 tape drives and DAT 160 cartridges

DAT 160 cartridges can only be used with DAT 160 tape drives; they are wider than earlier formats and will not fit into earlier tape drive models. DAT 160 cartridges provide optimum performance and maximum capacity for DAT 160 tape drives. DAT 160 tape drives are also backwards compatible with some earlier formats, see [Table 6-1](#) on page 32.

#### Compatibility

For optimum performance and storage capacity, use tape cartridges that match your drive's format, and normally use only one cartridge per day. Ideally, use:

- DAT 160 cartridges with DAT 160 tape drives

- DAT 72 cartridges with DAT 72 tape drives

Although DDS tape drives are fully backward compatible, old tape formats are more abrasive than later generations and using older tape formats can reduce the life expectancy of the tape drive. The compatibility between drive models and cartridges is summarized in [Table 6-1](#) on page 32. Shaded boxes show the recommended media for each tape drive. Capacities assume a compression ratio of 2:1.

**Table 6-1** Data cartridge compatibility

	<b>DDS-1 &amp; 2</b>	<b>DDS-3</b>	<b>DDS-4</b>	<b>DAT 72</b>	<b>DAT 160</b>
DAT 160	not supported	not supported	read/write	read/write	<b>read/write 160 GB*</b>
DAT 72	not supported	read/write	read/write	<b>72 GB*</b>	not supported
* Capacity assumes 2:1 compression.					

## Write-protecting cartridges

If you want to protect the data on a cartridge from being altered or overwritten, you can write-protect the cartridge.

Always remove the cartridge from the tape drive before you change the write protection.

- To write-protect a cartridge, slide the tab on the rear of the cartridge so that the recognition hole is open.
- To write-enable a cartridge, slide the tab back so that the hole is closed.

Write-protection will not protect your cartridges against magnets (or bulk erasers).

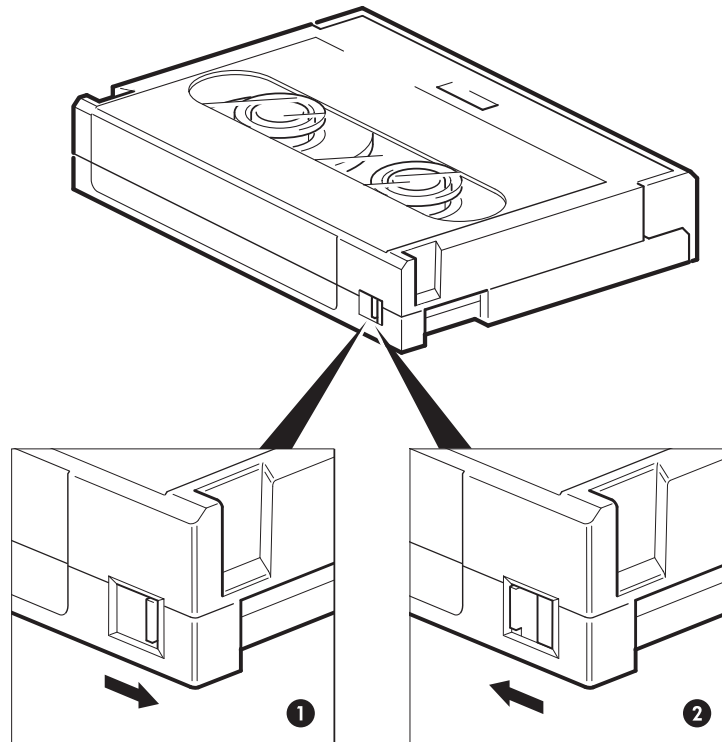

1. tab closed, cartridge write-enabled

2. tab open, cartridge write-protected

**Figure 6-1** Write protecting a cartridge

## Cleaning cartridges

**Table 6-2** Cleaning cartridge compatibility

Tape drive model	Cleaning cartridge required
DAT 160 tape drives	You must use a DAT 160 cleaning cartridge
All other DAT tape drives	You must use a standard DDS cleaning cartridge

Do not use swabs or other means of cleaning the heads. The cleaning cartridge uses a special tape to clean the tape heads. A cleaning cartridge can only be used 50 times or as instructed on the cartridge packaging. Always place a check mark in a box each time you use the cartridge to clean the drive. Replace the cleaning cartridge when all the boxes are checked. New cleaning cartridges are available from your manufacturer.

1. Insert a cleaning cartridge into the drive. The tape drive automatically loads the cartridge and cleans the heads.

At the end of the cleaning cycle, the drive ejects the cartridge. The cleaning cycle takes approximately 30-60 seconds.

If the cleaning cartridge is not ejected, it has probably expired. In this case, press the Eject button, discard the cleaning cartridge and repeat the operation with a new one.

2. Remove the cleaning cartridge from the drive.

The drive's TapeAlert feature will send a message to your backup application when the tape heads need cleaning or a cleaning cartridge has expired.

## Handling cartridges

- Do not touch the tape media.
- Do not attempt to clean the tape path or tape guides inside the cartridge.
- Do not leave cartridges in excessively dry or humid conditions.
- Do not leave cartridges in direct sunlight or in places where magnetic fields are present (for example, under telephones, next to monitors or near transformers).
- Do not drop cartridges or handle them roughly.
- Do not stick more than one label onto the cartridge label area; extra labels can cause the cartridges to jam in the drive. Stick labels onto the label area only.
- See the insert included with the tape cartridge for storage conditions.

## Getting the most out of cartridges and drives

- Use mostly the matching media type (DAT 160 media for DAT 160, DAT 72 media for DAT 72).
- Use media for the recommended number of times (DAT 160, DAT 72 =100 full backups). Overuse of the tape will cause it to degrade and possibly shed tape debris in the drive. Too many new tapes can also cause wear of the drive as they are rougher than used ones.
- Do not verify (DDS does read-after-write checking automatically).
- Do not overload the server during backups. Maximize the transfer rate (run overnight with no other processes) and use incremental backups if convenient.
- Do not overuse your tape drive—it is designed for approximately three hours of tape pulling per day, not constant usage—and clean the drive regularly. See “[Cleaning cartridges](#)” on page 33.

- If you want to bulk erase cartridges, this should be done in a controlled environment. You need to make sure there are no other cartridges with sensitive information on them anywhere near the bulk eraser when in use. All data will be lost on cartridges that are bulk erased.

## Notes

# 7

## Troubleshooting

In this chapter:

- [“General Procedure”](#) on page 37
- [“Verifying USB installation for optimum performance”](#) on page 38
- [“Problems with cartridges”](#) on page 40

### General Procedure

If a problem occurs, the first step is to try to establish whether the problem lies with the cartridge, the drive, the host computer and connections, or the way the system is being operated.

#### **Has the system just been installed?**

There could be an installation problem:

1. Check through the information in the relevant installation chapter of this guide.
2. Check the power connectors and SCSI cabling and USB cabling.
3. Are you connected to a USB 2.0 port? Are there any other devices attached to the same USB hub/controller? See also [“USB Configuration Guide”](#) on page 43.
4. Check the environmental conditions against the specified limits.
5. Are appropriate drivers and application software installed on the host?

#### **Are you using new cartridges or a different brand of cartridge? Have you been using the particular cartridge for a very long time?**

The problem could lie with the cartridge:

1. Check through [“Use the correct media”](#) on page 31.
2. Check that you are using a DDS-labeled cartridge—not a DAT cartridge.

3. Use the correct media type, for example:

- DAT 160 media with DAT 160 drives.
- DAT 72 media with DAT 72 drives.

Remember that although tape drives may be able to read earlier-format media, see [Table 6-1](#) on page 32, the media itself is not backward-compatible

- DAT 160 media can only be used with DAT 160 drives.
  - DAT 72 media can be used with DAT 160 and DAT 72 drives.
4. Has the cartridge been write-protected, see [“Write-protecting cartridges”](#) on page 32?
5. Clean the tape heads with the cleaning cartridge, see [“Cleaning cartridges”](#) on page 33. Be sure to use the correct cleaning cartridge.
- DAT 160 cleaning cartridges with DAT 160 tape drives.
  - Standard DDS cleaning cartridges with DAT 72 tape drives
6. Try the operation again.
7. If the problem still occurs, try using a different cartridge.
8. If the problem is still there, the problem probably lies with the drive or the host computer.

**Has the drive been moved recently? Have any cables been disconnected and reconnected? Has the environment changed—unusually hot, cold, damp or dry? Has there been dust or dirt near the drive. Have reasonable precautions against static been taken?**

The problem could lie with the drive:

1. Check the cables and connectors.
2. Clean the tape heads with the cleaning cartridge.
3. If the problem persists, check the environmental conditions against the specified limits (please visit the support pages at <http://www.tandbergdata.com>). Perhaps move the drive to a more suitable site.

**Has a new operating system been installed in the host computer? Has new backup software been installed?**

The problem could lie with the host or the software. Consult the computer's operating manuals, the software manual, or seek help from a service engineer.

## Verifying USB installation for optimum performance

To confirm that a USB DAT drive is installed correctly:

- Check that a USB 2.0 port is being used

- Ensure that the tape drive is the only device on a USB hub
- Ensure that the Tandberg Data USB driver is being used

### Check for USB 2.0 port (Windows)

It is important to ensure that you connect your drive to a USB 2.0 port. The drive will work on a USB 1.1 port but performance will be severely degraded.

To check the port on a Windows system:

1. Go to **Device Manager** and select **Devices by connection** from the View menu.
2. Expand **Universal Serial Bus controllers** and locate the tape drive.
3. If a USB driver is listed as **Enhanced**, the port is USB 2.0.

### Ensure that the tape drive is the only device on a USB hub (Windows)

On some computers multiple physical USB 2.0 ports will be connected to the same master port, known as a “root hub”. Connecting multiple devices to one root hub may degrade tape drive performance degradation.

USB Mass Storage devices like DAT tape drives have the lowest priority of all device types on the USB bus, so devices such as webcams should never be connected to the same root hub.

To check the devices connected to a root hub:

1. Go to **Device Manager** and select **Devices by connection** from the View menu.
2. Expand **Universal Serial Bus controllers** and locate the tape drive.
3. Trace the tree of devices back to the USB Root Hub and check that the only device connected is the tape drive via the **HP USB Mass Storage Device**.

### Ensure that the hp\_usbstor driver is being used (Windows)

The USB DAT drive will work with the Microsoft **usbstor** driver, however, we strongly recommend that you use the Tandberg Data USB driver for improved performance.

To check the driver being used:

1. Go to **Device Manager** and select **Devices by connection** from the View menu.
2. Expand **Universal Serial Bus controllers** and locate the tape drive.

3. If the tape drive is connected to the **HP USB Mass Storage Device**, it is configured correctly.

## Check drivers (Linux)

Use the following procedure to check that both drivers are present:

### 1. **usb\_storage** driver

- At the command prompt type:  
`lsmod | grep usb_storage`
- The output of this command should contain a line similar to:  
`usb_storage 61193 0`
- If this line is not present, type:  
`modprobe usb_storage`  
at the command line to load the usb-storage driver.

### 2. **st** tape driver

- At the command prompt type:  
`lsmod | grep st`
- The output of this command should contain a line similar to:  
`st 35933 0`
- If this line is not present, type:  
`modprobe st`  
at the command line to load the st driver.

## Problems with cartridges

If you experience any problems using branded cartridges, check:

- The cartridge case is intact and that it contains no splits, cracks or damage.
- The cartridge has been stored at the correct temperature and humidity. This prevents condensation. See the insert included with the tape cartridge for storage conditions.
- The write-protect switch is fully operational. It should move from side to side with a positive click.
- <http://www.tandbergdata.com> for more detailed troubleshooting information.

## The cartridge is jammed

If the cartridge is jammed or the backup application is unable to eject it, you can force eject the cartridge. Once the cartridge is successfully ejected, it is good practice to upgrade the firmware. If the failure occurs regularly, contact customer service via <http://www.tandbergdata.com>.

1. Either press and hold the Eject button on the front of the tape drive for at least 15 seconds. Or press the Eject button three times within 5 minutes.
2. Wait for the cartridge to be ejected. The drive waits until 35 seconds have passed from the time of the first press, to give the normal eject procedure a chance to proceed. After this period, it immediately releases the tape and ejects the cartridge, regardless of what operation it was performing. It is important that you allow sufficient time for the drive to complete this process. If you interrupt it, you may damage the media or the tape drive. The drive is then reset as though you had turned the power off and then on again.

You may lose data if you force eject a cartridge. The tape may also become unreadable because an EOD (End of Data) mark may not be properly written.

3. If the cartridge is still jammed, the tape drive has failed. Contact customer service.

## The drive will not accept the cartridge (or ejects it immediately)

The cartridge may have been damaged, for example dropped, or the drive may have a fault. If it is a cleaning cartridge, it has probably expired and should be discarded immediately.

For data cartridges:

1. Check that the drive has power (the power cable is properly connected and the Tape LED is on).
2. Check that you are using the correct media for the tape drive, see “[Use the correct media](#)” on page 31.
3. Make sure that you have loaded the cartridge with the correct orientation (see “[Loading and unloading cartridges](#)” on page 28).
4. Check for damage to your media and discard it if it is damaged.
5. Use a new or known-good piece of media and see if it loads. If it does, the original cartridge is faulty and should be discarded.
6. Check if another DAT drive of the same model will accept the cartridge. If it does, the original drive may be faulty.

## Notes

# 8

## USB Configuration Guide

In this chapter:

- “[USB in DAT devices](#)” on page 43
- “[USB terminology](#)” on page 43
- “[Setting up a USB network](#)” on page 44
- “[USB cables](#)” on page 45

### USB in DAT devices

The DAT tape drive is a USB 2.0 logo certified device. It supports the high-speed USB transfer rate with a theoretical maximum transfer of over 50 MB/s. (The actual backup rate will be less. This is defined by the transfer rate of the tape drive and the compressibility of the data.)

To benefit from the high-speed performance of the USB 2.0 interface, the USB DAT tape drive should be connected to its host system via a USB 2.0 port. Any USB hubs between the tape drive and the system port should also be USB 2.0 compliant.

To maximize tape drive performance, minimize the use of other USB devices when using the USB tape drive.

### USB terminology

The Universal Serial Bus, USB, is a communication interface where an intelligent host controls all the network activity. A command from the host to a particular device is broadcast to all devices on the network. A device waits for a command addressed to itself and then responds as requested. The host determines how much of the overall USB network bandwidth a given device can use at any time. Any given USB network has only one host.

Hubs act as command repeaters and multipliers. This allows many devices to be supported by one host. A host command can arrive at the upstream port of the hub and be transmitted via the downstream ports to many other device and hubs. (Likewise, device commands arriving at a downstream port are also repeated upstream.) There is a special hub called a root hub. The root hub's upstream port is connected directly to the host. All USB systems have a root hub. This is why a system typically has more than one USB port. All the USB ports on the system are connected to the host system via the root hub.

USB devices are not treated equally by the host.

- Periodic devices, which consist of interrupt and isochronous devices, are given a higher priority than bulk transfer devices.
- Interrupt devices, such as keyboards and mice, typically send brief but important input information to the system.
- Isochronous devices, such as web cameras, typically require timely transmission of data, such as a video stream.
- Bulk transfer, such as printers and CD-ROM, must receive or transmit 100% accurate data. But how fast or often the data is transmitted is not as important as the accuracy of the data.

The host will give network bandwidth priority to periodic devices and will share any remaining bandwidth equally among any active bulk transfer devices.

USB supports many types of devices and three data transfer rates, low speed, full speed, and high speed. (A keyboard does not need to transfer data to the system at the same speed as a cable modem.)

The transfer speed capabilities of a device are often referred to by the USB specification revision in which the transfer rate was defined. Therefore a USB 2.0 Hub will support high, full and low speed, but a USB 1.1 hub will only support full and low speed.

The USB specification was developed and is maintained by the USB organization. The USB organization also conducts a certification program. The USB organization will issue the USB logo to a device, which has passed a series of tests that verify the device has correctly implemented the USB interface, as defined by the USB specification. There are many types of USB logos depending on which features of the USB specification a device supports. A USB 2.0 logo-ed device correctly supports high, full, and low speed data transfer.

## Setting up a USB network

USB is very user friendly. The interface automatically assigns addresses to devices; you simply need to connect a USB device to a USB port on a system using a USB cable. If you have many USB devices or need to place a device away from your system, you may place up to a maximum of five USB hubs between the device and host system and connect them with additional cables.

If you are using a high-speed (USB 2.0) device, make sure that the USB host at the system and all the hubs between the device and host support high-speed (USB 2.0) transfer.

When using a bulk transfer device, such as a tape drive, do not use other USB devices that will place restrictions on the USB bandwidth available to the bulk transfer device.

If several USB device requiring large amounts of the USB network bandwidth are to operate simultaneously, an additional host must be added to the system. Each device must then be placed into the separate networks starting at the different hosts. An additional host is typically a new USB HBA, which plugs into the host system's PCI slot, creating a new USB host that resides on the network.

**Note:**

If several USB adapters are placed into a system, demands on the bandwidth of the system bus will constrain the USB devices' performance.

Always use USB logo-ed components in your USB network. This is the best and easiest method to ensure reliable operation.

## USB cables

USB cables are available in a variety of lengths. The maximum cable length is 5 meters. If you need to place a USB device further than 5 meters from the system, you must use a hub.

Do not use USB cable extenders or couples. These are not recognized or approved by the USB organization. The USB specification does not allow their use and they are likely to reduce the reliability of the USB network or cause it not to work completely.

Internal and external USB devices use the same USB cables.

## Notes

# Index

## A

audience, VII

## B

backup software  
supported, 12  
buttons  
Unload, 29

## C

cartridge life, 34  
cartridges  
See  
best use of, 34  
cleaning, 33  
compatibility, 31  
handling, 34  
inserting, 28  
jammed, 41  
loading, 28  
not accepted, 41  
power off, 29  
problems, 37  
removing, 29  
unloading, 29  
write protecting, 32  
cleaning cartridges, 33  
compatibility  
backup software, 12  
conventions  
document, VII  
text symbols, VIII

## D

DAT 160 cartridges, 31

DAT tape drive  
front view, 9, 24  
LEDs, 25  
loading, 28  
models supported, 9  
powering off, 29  
unloading, 29

document  
conventions, VII

drive  
operating, 24

drivers  
installing, 12  
unix, 12  
windows, 11

## E

eject button, 29

## F

firmware, upgrading  
drives, 29  
front panel  
drives, 24  
front view, 9, 24

## H

handling cartridges, 34  
help  
obtaining, VII

## I

inserting cartridges, 28  
installation, 37  
problems, 37  
troubleshooting, 37  
verifying, 21  
installing  
drivers, 12  
internal drive, 13  
installing internal  
attach mounting hardware, 14  
prepare mounting bay, 14  
secure drive, 17

## J

jammed cartridge, 41

- L**
- LEDs, [25](#)
  - at power on, [21](#)
- loading
  - cartridges, [28](#)
- loading cartridges, [28](#)
  
- M**
- media
  - See cartridges
- models supported, [9](#)
- mounting requirements, [13](#)
  
- O**
- online, [28](#)
- operating systems supported, [10](#)
- operation
  - drives, [24](#)
  - troubleshooting, [38](#)
  
- P**
- power off, [29](#)
- power on button, [24](#)
- product specification
  - See
  
- S**
- software
  - troubleshooting, [38](#)
- supported operating systems, [10](#)
- symbols in text, [VIII](#)
  
- T**
- technical support, [VII](#)
- text symbols, [VIII](#)
- troubleshooting
  - cartridge ejected, [41](#)
  - cartridges, [37](#)
  - general, [38](#)
  - general procedure, [37](#)
  - installation, [37](#)
  - jammed cartridge, [41](#)
  - LEDs, [25](#)
  - software, [38](#)
  
- U**
- unix
  - drivers, [12](#)
- Unload button, [29](#)
  
- unloading cartridges, [28](#), [29](#)
- upgrading firmware
  - drives, [29](#)
  
- V**
- verify installation, [21](#)
  
- W**
- write protect, [32](#)